

CKNN05-WEB - L-SERIES ENGINE L24 (240Z), L26 (260Z) & L28 (280Z)

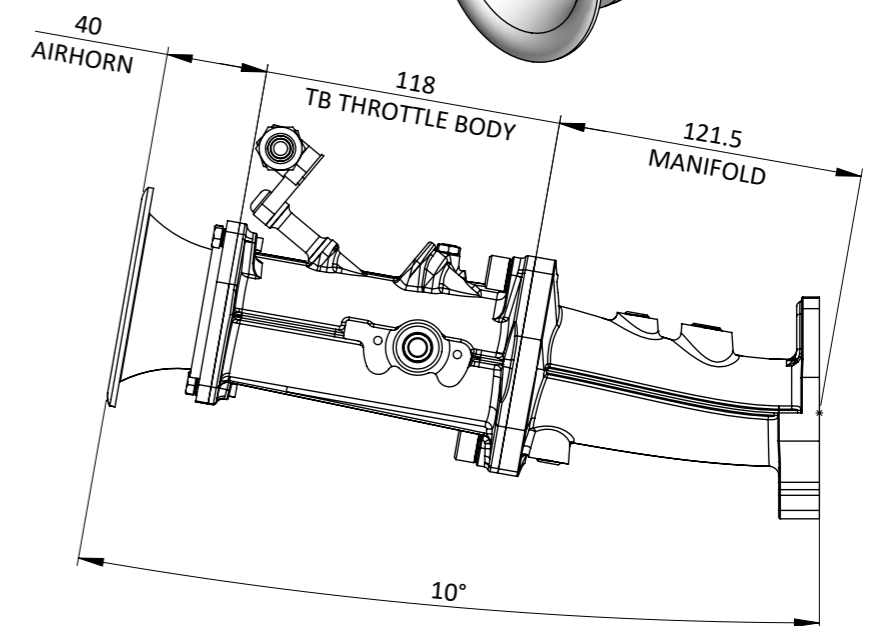

Engineered to win

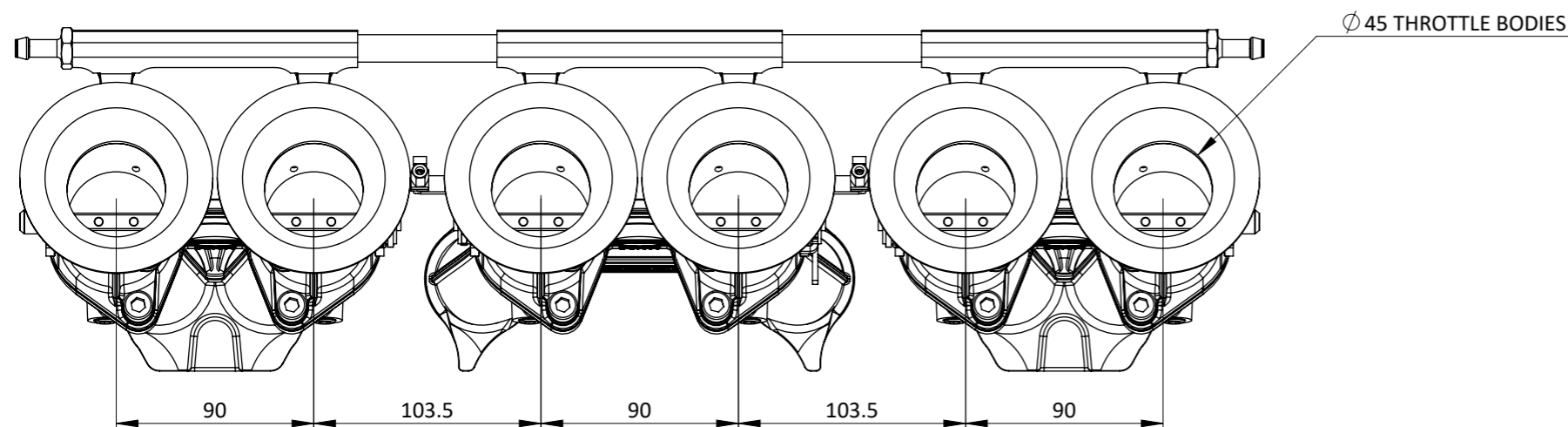
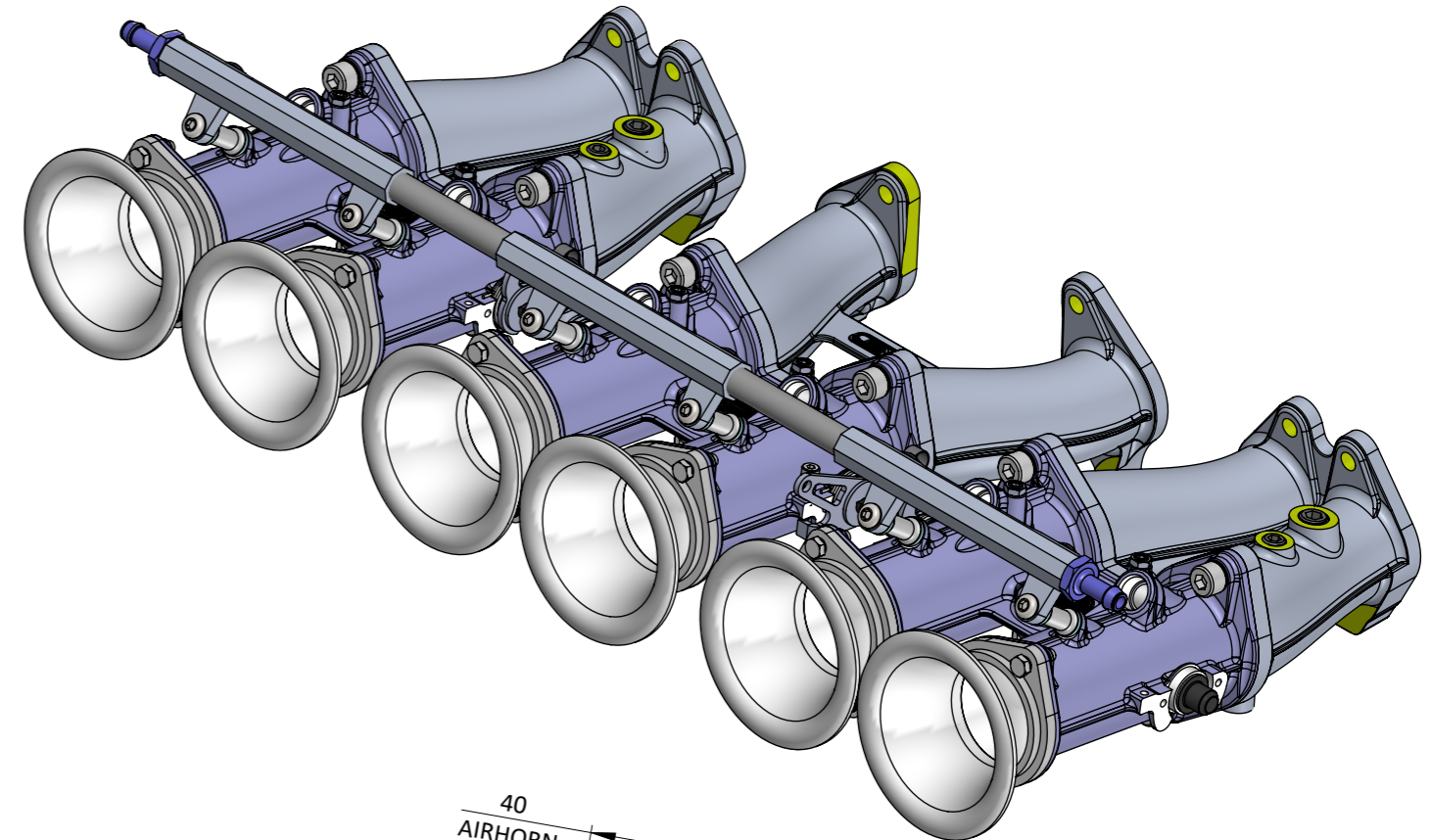
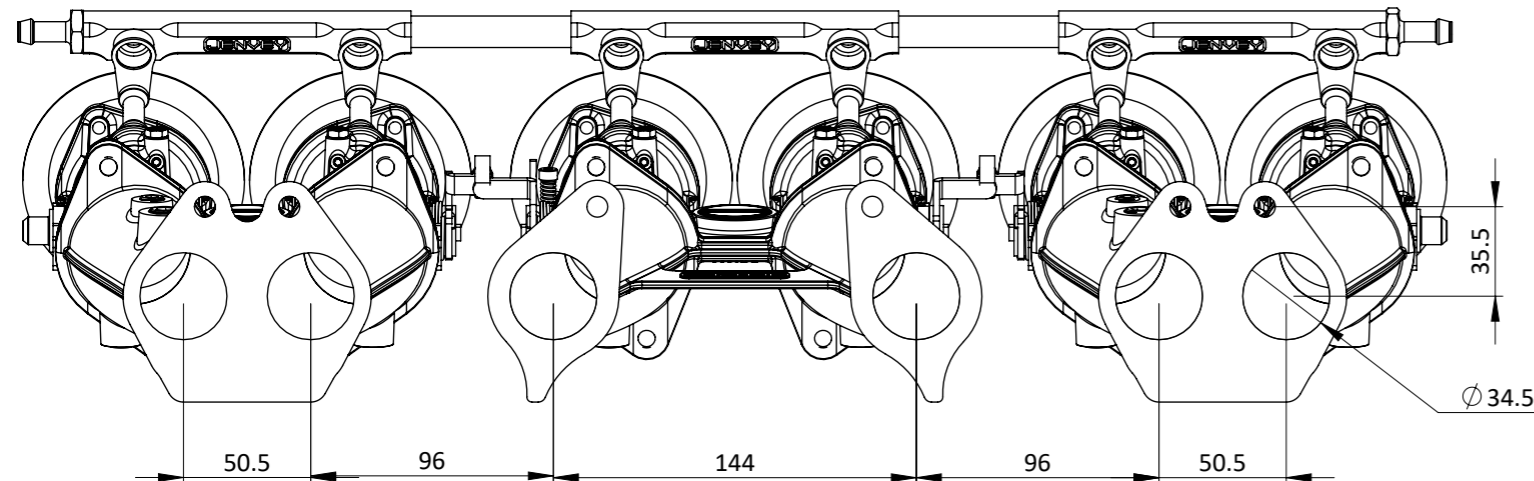

NISSAN DATSUN ITB KIT FOR THE 240Z, 260Z, 280Z, 280ZX.

THIS SET OF MANIFOLDS FITS TO THE DATSUN L-SERIES 6 CYLINDER ENGINES (L24, L26 & L28)
THE MANIFOLD HAS A 45mm INLET (WHICH CAN BE PORTED UP TO 48mm) AND 34.5mm OUTLET
IT CAN BE USED WITH ANY DCOE STYLE FLANGE THROTTLE BODY.

MANIFOLDS INCLUDES TAKE OFF BOSSES FOR IDLE CONTROL VALVES/ BRAKE BOOST ETC
2X 1/4" & 2X 1/8" NPT TAPPED BOSSES ON TOPSIDE OF MANIFOLD
6X 1/8" NPT TAPPED BOSSES ON THE UNDERSIDE, ONE PER RUNNER

SEE KIT 'CKNN03' FOR BIG THROTTLE BODY APPLICATIONS (50MM+)
FOR BACKPLATE AND FILTER SEE 'ABF-KIT-MN05'. INCLUDES FLAT CARBON BACKPLATE AND 100mm FILTER.

Frame: 1 of 1

Version: 1

Tel 01746 768810

© JENVEY DYNAMICS LTD. 2021

Web WWW.JENVEY.CO.UK

